

whiteley helyar



510 ft²



bedroom



bathroom



*on-street
parking*

Guide Price £275,000

95b Newbridge Road, Bath, BA1 3HF

A charming one bedroom garden flat, currently used as a holiday let, with south facing garden and no onward chain. Perfect as a first time purchase, or for investors, the property benefits from a private entrance and some lovely period features.

ACCOMMODATION

Sitting room with feature fireplace and glazed door to the garden
Fitted kitchen with dining area

Bay-fronted double bedroom with built-in wardrobe
Modern bathroom with window

EXTERNALLY

From the sitting room, you step onto a very private terrace – a perfect spot for those outdoor meals. The remainder of the garden is laid to lawn, bordered by a small fence and enjoying that lovely southerly outlook.

LOCATION

The flat occupies an extremely convenient position, just a short walk from the extensive range of cafes, shops and amenities on Chelsea Road and in Weston village, and is just over a mile from the city centre. The Royal United Hospital is also a short walk away, whilst the property is well served by buses to the centre of Bath and easy access to the M4 is available without having to cross the city.





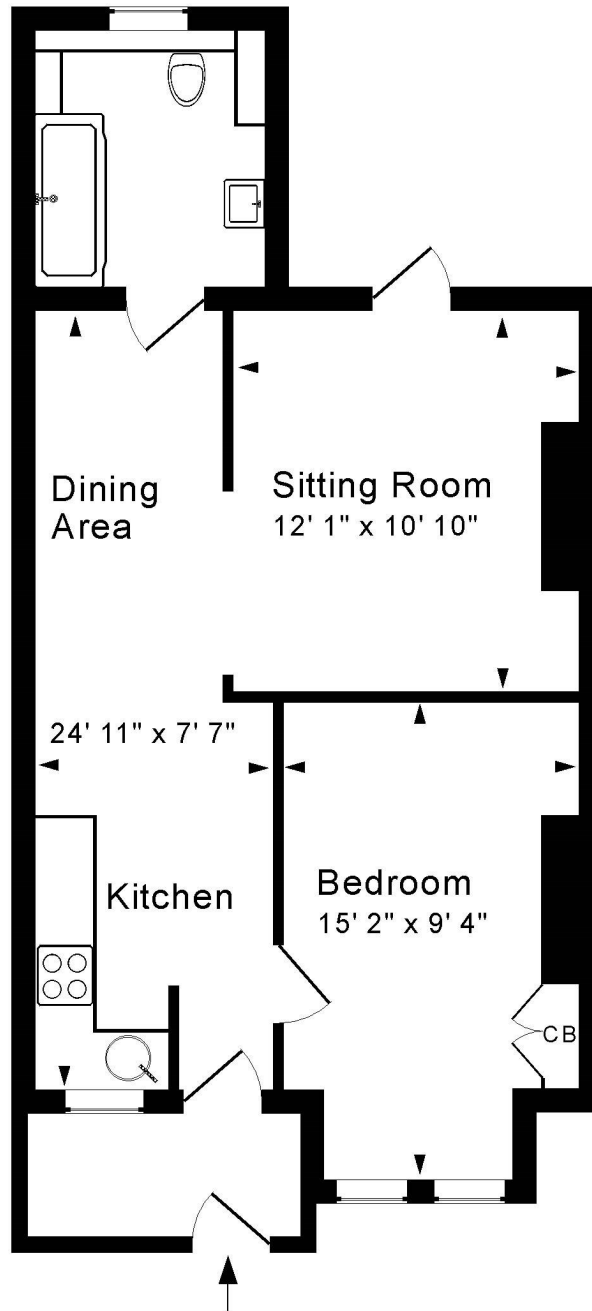

Tenure: Leasehold
Council Tax: TBC

Lower Ground Floor

Approx. Gross Internal Floor Area 510 Sq. Ft. / 47 Sq. M
Excludes Entrance Porch
For identification purposes only. Not to scale. Copyright Jemesis Ltd 2024
Drawing Number: 172-0771
95B Newbridge Road, Bath, BA1 3HF.

